

Test program and Diagnosis menu for the models "Royal"



Royal Exclusive
senza ® Rapid steam



Royal Digital
senza ® Rapid steam



Royal Digital
® Rapid steam



Royal Digital
® Insta steam

Index

Test program ROYAL PROFESSIONAL REDESIGN.....	3
Test program ROYAL PROESSIONAL NEW SYSTEM.....	5
Test program ROYAL DIGITAL.....	7
Test program ROYAL CAPPUCCINO.....	9
Test program ROYAL OFFICE.....	11
Test program ROYAL CLASSIC.....	13
Test program ROYAL DIGITAL PLUS REDISIGN.....	15
Test program ROYAL CAPPUCCINO REDESIGN.....	17
DIAGNOSIS MENU for all the ROYAL models.....	20

Test program ROYAL PROFESSIONAL REDESIGN

In test program it is very easy to locate the broken parts and the time to adjust it becomes lesser.

To enter in test program the machine has to be turned off or in "stand by" and with the hot water steam knob closed.

These functions can be followed by all the Royal models, because there are almost the same.

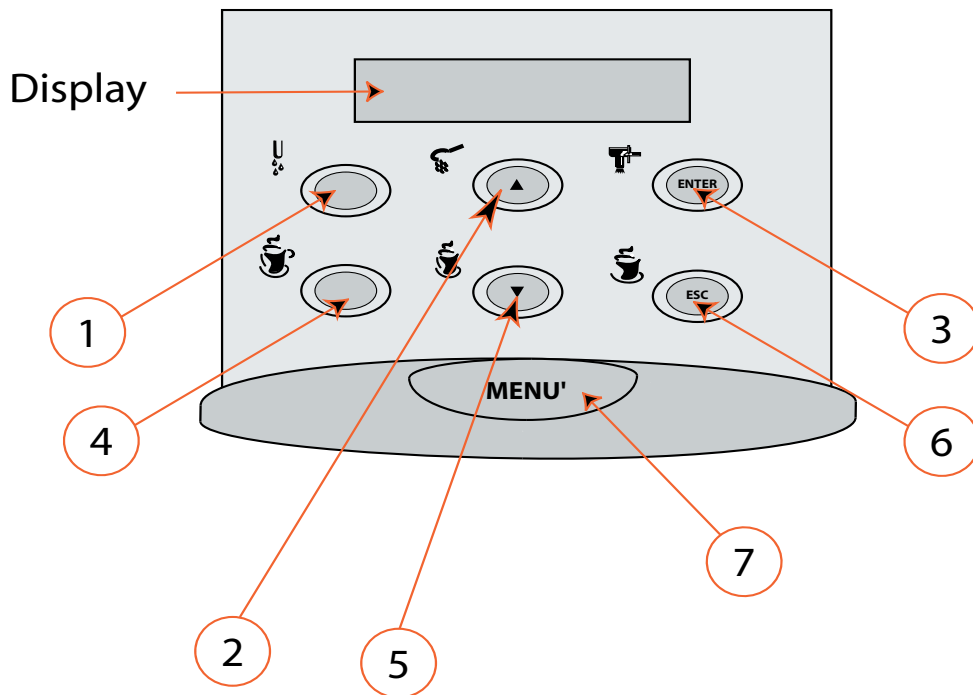

For entering in test program push the following key's.

Push at the same time the key's 2 and 6 turn on the machine by the main switch.
Remaining in this position the display is indicating the version of the software.
Let go of the keys. Now the machine is in test program.

Rotation anticlockwise of the gear motor

Key 1

Check the right rotation anticlockwise of the gear motor by checking also the end position
When the gear motor is in work position, on the display it will appear number 1. Check also that the gear motor isn't noisy.

Rotation clockwise of the gear motor.

Key 2

Check the right rotation clockwise of the gear motor by checking also the end position.
When the gear motor is in home position, on the display it will appear number 2. Check also that the gear motor isn't noisy.

Function coffee grinder

Key 3

Check the right function of the coffee grinder and that it is rotating clockwise. Check the noise of the coffee grinder.

When the doser is full, the coffee grinder stops, and on the display appears N° 3

Opening of the doser.

Key 4

Check the right opening of the doser. Check that the doser isn't noisy.

Absorbing big resistance coffee boiler.	Key's 5 + 2
	Check that the big resistance of the coffee boiler is absorbing.
Absorbing small resistance coffee boiler	Key's 5 + 3
	Check that the small resistance of the coffee boiler is absorbing.
Absorbing resistance steam boiler	Key's 5 + 4
	Check that the resistance of the steam boiler is absorbing
Function of the pump	Key's 6 + 4
	Check the right function of the pump. Confirm the noise of the pump. On the display the impulses of the flow meter has to rise up to 40.
Leakages inside the machine	Key's 6 + 3 + 4
	Push the keys in sequence and keep them pushed so the circuit is going into pressure. Now it's possible to check if there are leakages inside the machine. On the display the impulses of the flow meter has to fall until 0
Water flow of the cappuccino device	Key's 3 + 6 + 7
	Check that the water is coming out of the cappuccino device. Check that all of the key's are switched on.
Temperature of the boilers.	Key's 4 + 5 + 6
	Check the temperature of the boilers
Function solenoid valve of the steam boiler	Key's 6 + 4
	Check that the solenoid valve positioned on the steam boiler is opening.
Function solenoid valve for hot water	Key's 6 + 2
	Check that the solenoid valve for hot water is opening
Opening of both of the solenoid valves.	Key's 6 + 3
	Check the right opening of both of the solenoid valves.
Opening of the solenoid valve cappuccino device	Kay's 6 + 7
	Check that the solenoid valve of the cappuccino device is opening.
Check all the micro switches.	
	Check that on the display appears N°7 (reed sensor for water). Turn the steam knob, check that the micro engages is halfway round and that on the display appears number 4. Activate the micro presence brewing unit and check that on the display appears N° 6. Remove the coffee grounds container ,and check that on the display number 5 is switched off. Activate the micro doser unit and check that on the display appears number 3.
Exit the test program.	The main switch
	Turn off the machine and then turn it on again

Test program ROYAL PROFESSIONAL NEW SYSTEM

In test program it is very easy to locate the broken parts and the time to adjust it becomes lesser. To enter in test program the machine has to be turned off or in "stand by" and with the hot water steam knob closed.

These functions can be followed by all the Royal models, because there are almost the same.

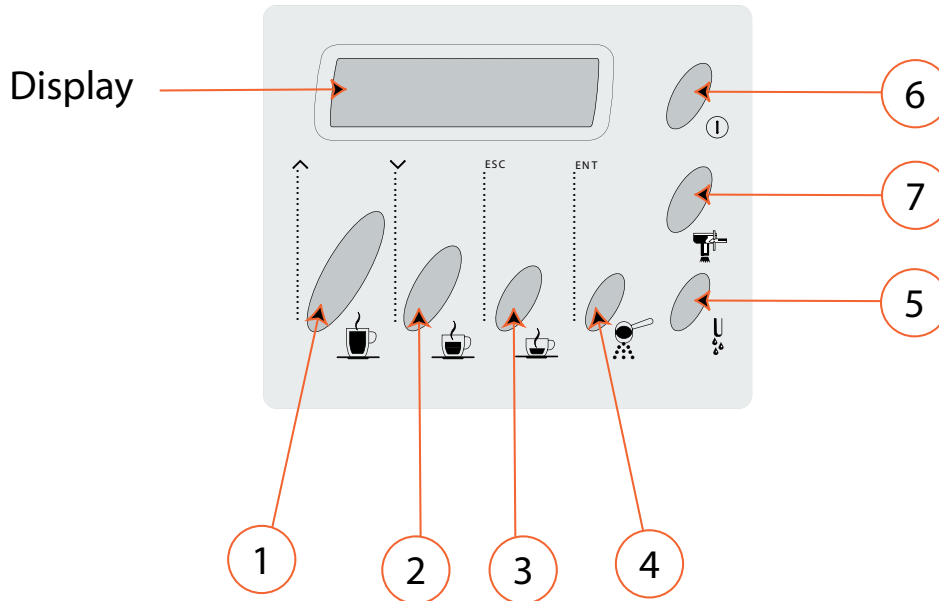

For entering in test programs push the following key's.

Check that on the display it appears the text "Save energy" or push the key N° 6.
Push at the same time the key's 2 and 3 and then push the key N°6

Rotation anticlockwise gear motor

Key 1

Check the right rotation anticlockwise of the gear motor by checking also the end position.

When the gear motor is in work position, on the display it will appear number 1.. Check also that the gear motor isn't noisy.

Rotation clockwise gear motor

Key 2

Check the right rotation clockwise of the gear motor by checking also the end position.

When the gear motor is in home position, on the display it will appear number 2. Check also that the gear motor isn't noisy.

Function coffee grinder

Key 3

Check the right function of the coffee grinder and that it is rotating clockwise. Check the noise of the coffee grinder.

When the doser is full, the coffee grinder stops, and on the display appears N° 3.

Opening of the doser

Key 4

Check the right opening of the doser. Check that the doser isn't noisy.

Absorbing big resistance coffee boiler

Key's 5 + 2

Check that the big resistance of the coffee boiler is absorbing

Absorbing small resistance coffee boiler	Key's 5 + 3
	Check that the small resistance of the coffee boiler is absorbing
Absorbing resistance steam boiler	Key's 5 + 4
	Check that the resistance of the steam boiler is absorbing
Function of the pump.	Key's 6 + 4
	Check the right function of the pump. Confirm the noise of the pump. On the display that the impulses of the flow meter is rising up to 40
Leakages inside the machine	Key's 1 + 3 + 6
	Push the key's in sequence and keep them pushed so the circuit is going into pressure. Now it's possible to check if there is leakages inside the machine. On the display the impulses of the flow meter has to fall until 0
Function solenoid valve of the steam boiler	Key's 6 + 2
	Check the right function of the solenoid valve positioned on the steam boiler
Function solenoid valve for hot water	Key's 6 + 3
	Check the right function of the solenoid valve for hot water
Opening of both solenoid valves	Key's 6 + 4
	Check the right opening of the both solenoid valves
Function solenoid valve of the cappuccino device	Key's 6 + 7
	Check the right function of the solenoid valve for the cappuccino device.
Check all the micro switches	
	Check that on the display appears N°7 (reed sensor for water). Turn the steam knob, check that the micro engages is halfway round and that on the display appears number 4. Activate the micro presence brewing unit and check that on the display appears N° 6. Remove the coffee grounds container ,and check that on the display number 5 is switched off. Activate the micro doser unit and check that on the display appears number 3.
Exit the test programs	The main switch
	Turn off the machine and then turn it on again.

Test program ROYAL DIGITAL

In test program it is very easy to locate the broken parts and the time to adjust it becomes lesser To enter in test program the machine has to be turned off or in "stand by" and with the hot water steam knob closed.

These functions can be followed by all the Royal models, because there are almost the same.

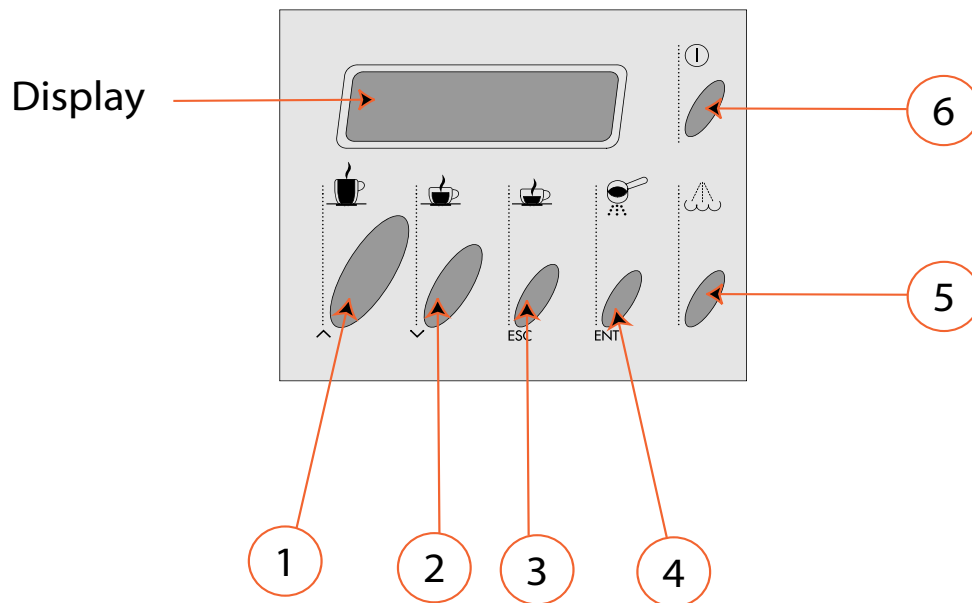

For entering in the test program push the following key's

Confirm that on the display it appears the text "Save energy" or push the key N° 6.

Push at the same time the key's 2 and 3 and then push the key N°6.

Rotation anticlockwise gear motor

Key 1

Check the right rotation anticlockwise of the gear motor by checking also the end position

When the gear motor is in work position, on the display it will appear number 1. Check also that the gear motor isn't noisy.

Rotation clockwise gear motor

Key 2

Check the right rotation clockwise of the gear motor by checking also the end position.

When the gear motor is in home position, on the display it will appear number 2. Check also that the gear motor isn't noisy.

Function coffee grinder

Key 3

Check the right function of the coffee grinder and that it is rotating clockwise. Check the noise of the coffee grinder.

When the doser is full, the coffee grinder stops, and on the display appears N° 3

Opening of the doser

Key 4

Check the right opening of the doser. Check that the doser isn't noisy.

Absorbing resistance coffee boiler**Key's 5 + 2**

Check that the coffee boiler is absorbing

Function of the pump**Open steam knob + key's 1+6**

Check the right function of the pump. Check the noise of the pump.
Check that the impulses of the flow meter is rising until 40

Leakages inside the machine**Closed steam knob + key's 1+6**

Push the key's in sequence and keep them pushed so the circuit is going into pressure.

Now it's possible to check if there is leakages inside the machine.

On the display the impulses of the flow meter has to fall until 0.

Check all the micro units

Check that on the display appears N°7 (reed sensor far water).
Turn the steam knob, confirm that the micro engages is halfway round and that on the display appears number 4.

Activate the micro presence brewing unit and check that on the display appears N° 6.

Remove the coffee grounds container, and check that on the display number 5 is switched off.

Activate the micro doser unit and check that on the display appears number 3

Exit the test programs.

Turn off the machine and then turn it on again

Test program ROYAL CAPPUCCINO

In test program it is very easy to locate the broken parts and the time to adjust it becomes lesser
To enter in test program the machine has to be turned off or in "stand by" and with the hot water steam knob closed.

These functions can be followed by all the Royal models, because there are almost the same.

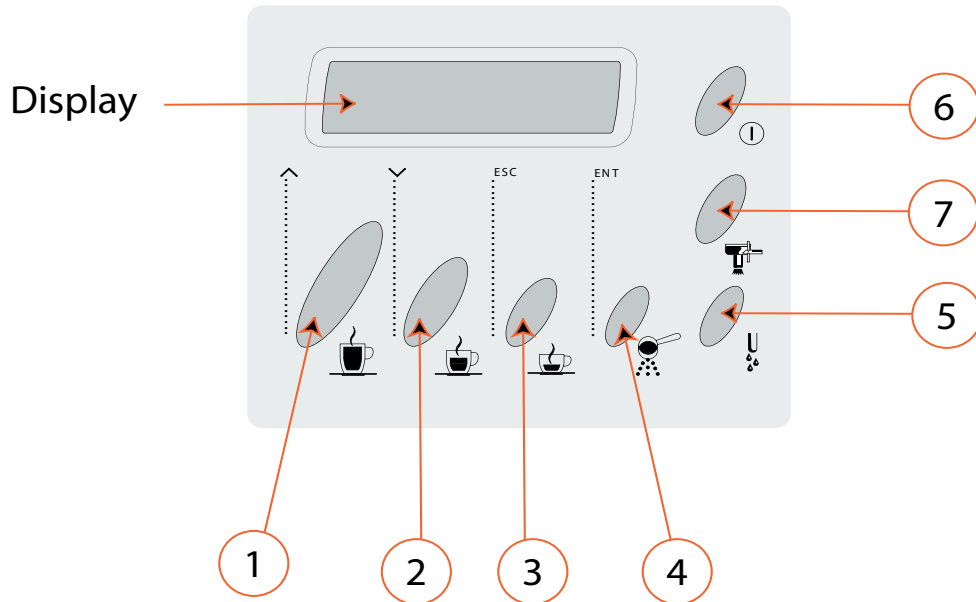

For entering in test programs push the following key's

Confirm that on the display it appears the text "Save energy" or push the key N° 6.

Push at the same time the key's 2 and 3 and then push the key N°6.

Rotation anticlockwise gear motor

Key 1

Check the right rotation anticlockwise of the gear motor by checking also the end position

When the gear motor is in work position, on the display it will appear number 1. Check also that the gear motor isn't noisy.

Rotation clockwise gear motor.

Key 2

Check the right rotation clockwise of the gear motor by checking also the end position.

When the gear motor is in home position, on the display it will appear number 2. Check also that the gear motor isn't noisy.

Function coffee grinder

Key 3

Check the right function of the coffee grinder and that it is rotating clockwise. Check the noise of the coffee grinder.

When the doser is full, the coffee grinder stops, and on the display appears N° 3

Opening of the doser

Key 4

Check the right opening of the doser. Check that the doser isn't noisy.

Absorbing big resistance coffee boiler	Key's 5 + 2
Check that the big resistance of the coffee boiler is absorbing	
Absorbing small resistance coffee boiler	Key's 5 + 3
Check that the small resistance of the coffee boiler is absorbing	
Absorbing resistance steam boiler	Key's 5 + 4
Check that the resistance of the steam boiler is absorbing	
Function of the pump	Key's 6 + 4
Check the right function of the pump. Check the noise of the pump. Check on the display that the impulses of the flow meter is rising up to 40	
Function of the pump 2 (steam)	Key's 3 + 5 + 6
Check the right function of the pump 2. Check the noise of the pump 2. On the display the impulses of the flow meter has to rise up to 40.	
Leakages inside the machine	Key's 6 + 1 + 5
Push the key's in sequence and keep them pushed so the circuit is going into pressure. Now it's possible to check if there is leakages inside the machine. On the display the impulses of the flow meter has to fall until 0.	
Function solenoid valve of the steam boiler	Key's 6 + 2
Check the right function of the solenoid valve positioned on the steam boiler	
Function solenoid valve for hot water	Key's 6 + 3
Check the right function of the solenoid valve for hot water	
Opening of both solenoid valves	Key's 6 + 4
Check the right opening of the both solenoid valves	
Function solenoid valve of the cappuccino device	Key's 6 + 7
Check the right function of the solenoid valve for the cappuccino devise.	
Function of all solenoid valve	Key's 4 + 6 + 7
Check the right function of all the solenoid valve Check that it comes water out of cappuccino device and of the steam tube.	
Check all the micro switches	
Check that on the display appears number 7 (reed sensor for water). Turn the steam knob, check that the micro engages is halfway round and that on the display appears number 4. Activate the micro presence brewing unit and confirm that on the display appears N° 6. Remove the coffee grounds container, and check that on the display number 5 is switched off. Activate the micro doser unit and check that on the display appears number 3	
Exit the test programs	
Turn off the machine and then turn it on again	

Test program ROYAL OFFICE

In test program it is very easy to locate the broken parts and the time to adjust it becomes lesser To enter in test program the machine has to be turned off or in "stand by" and with the hot water steam knob closed.

These functions can be followed by all the Royal models, because there are almost the same.

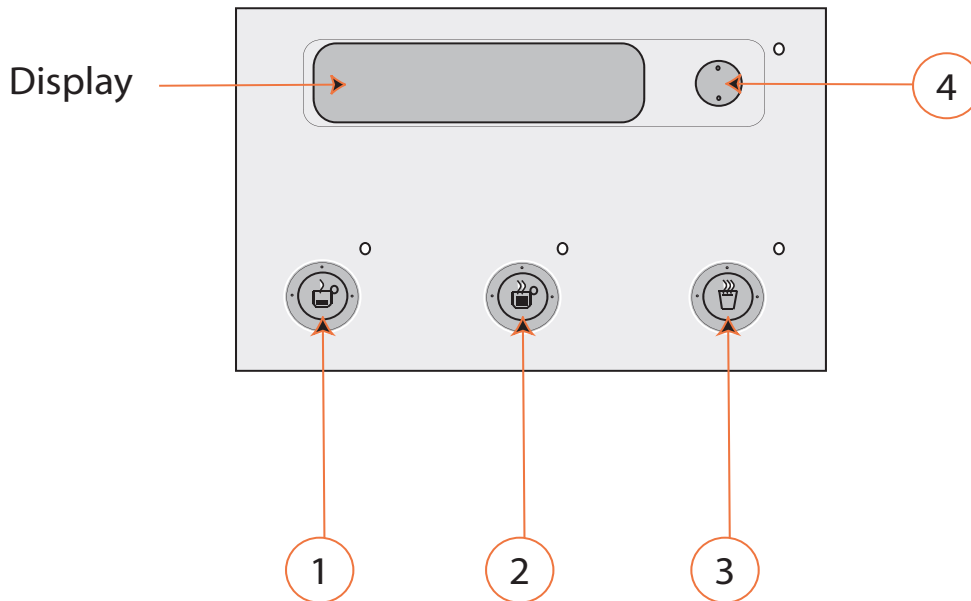

For entering in test programs push the following key's.

Turn off the machine. Push the key's 1 and 3 turning on the machine with the main switch.

Push the key 4 until on the display appears the text "M1"

Rotation anticlockwise gear motor

Key 1

Check the right rotation anticlockwise of the gear motor by checking also the end position

When the gear motor is in work position, on the display it will appear number 1. Check also that the gear motor isn't noisy.

Rotation clockwise gear motor

Key 2

Check the right rotation clockwise of the gear motor by checking also the end position.

When the gear motor is in home position, on the display it will appear number 2. Check also that the gear motor isn't noisy.

Absorbing big resistance of the coffee boiler

Key 3

Check that the big resistance of the coffee boiler is absorbing correctly

Push the key 4 until on the display appears the text "M2"

Function coffee grinder

Key 1

Check the right function of the coffee grinder and that it is rotating clockwise. Check the noise of the coffee grinder.

When the doser is full, the coffee grinder stops, and on the display appears N° 3

Opening of the doser

Key 2

Check the right opening of the doser
Check that the doser isn't noisy

Absorbing small resistance of the coffee boiler

Key 3

Check that the small resistance of the boiler is absorbing correctly

Push the key 4 until on the display appears the text "M3"

Function of the pump

Key's 1 + 3

Check the right function of the pump. Check the noise of the pump.
Check that the impulses of the flow meter is rising until 40

Leakages inside the machine

Continue pushing Key 1

Now the circuit has gone into pressure. Now it's possible to check if there is leakages inside the machine.
On the display the impulses of the flow meter has to fall until 0

Function solenoid valve for hot water

Key 3

Check the right function of the solenoid valve for hot water

Check all the micro units

Check that on the display appears N°7 (reed sensor for water).

Activate the micro doser unit and check that on the display appears N° 3.

Remove the coffee grounds container, and check

that on the display number 5 is switched off.

Activate the micro presence brewing unit and check that on the display appears N° 3.

Exit the test programs

The main switch

Turn off the machine and then turn it on again

Test program ROYAL CLASSIC

In test program it is very easy to locate the broken parts and the time to adjust it becomes lesser.

To enter in test program the machine has to be turned off or in "stand by" and with the hot water steam knob closed.

These functions can be followed by all the Royal models, because there are almost the same.

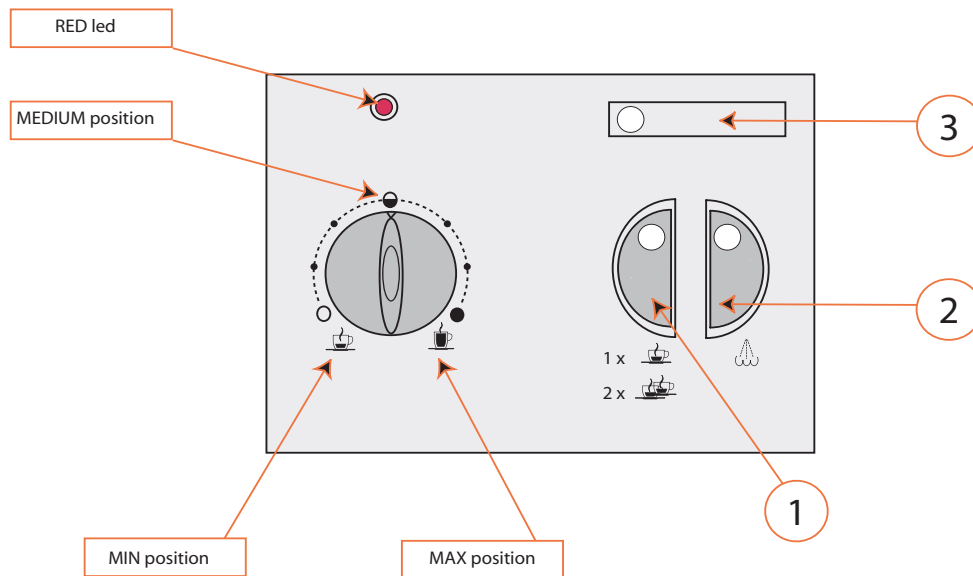

For entering in test programs push the following key's

Turn of the machine.
Push the key's 1, 2 and 3.

Turn the coffee regulation knob into the MINIMUM position

Rotation anticlockwise gear motor

Key 2

Check the rotation anticlockwise of the gear motor, check also the end position.

Check the noise of the gear motor.

When the gear motor is in work position, the led installed on the key 1 has to go on

Function of the pump

Key 1

Check the right function of the pump. Check the noise of the pump. Opening the water knob the red led has to blink to indicate that the flow meter is reading

Leakages inside the machine

Close the water knob by continuing to push key 1

Doing this the circuit is going into pressure. Now it's possible to check if there is leakages inside the machine.

The red led has to stop blinking.

Turn the coffee regulation knob into the MEDIA position

Absorbing boiler

Key 1

Check that the boiler is absorbing correctly

Rotation clockwise gear motor**Key 2**

Check the rotation clockwise of the gear motor, check also at the end position.
 Check that the gear motor isn't noisy.
 When the gear motor is in home position, the led installed on the key 1 has to go on.

Turn the coffee regulation knob into the MAXIMUM position**Opening of the doser****Key 1**

Check the right opening of the doser.
 Check that the doser isn't noisy.

Function of the coffee grinder**Key 2**

Check the right rotation of the coffee grinder.

Check the noise of the coffee grinder.

Check all the micro switch

Turn the steam knob, check that the micro engages is halfway round and that the led on the key 2 goes on.

Activate the micro presence brewing unit and check that the red led is always switched on .

Activating the micro presence brewing unit, and removing the coffee grounds container confirming that the red led is blinking.

Activate the micro doser and check that the red led on the key 2 is switched on.

Exit the test programs**The main switch**

Turn off the machine and then turn it on again

Test program ROYAL DIGITAL PLUS REDESIGN

In test program it is very easy to locate the broken parts and the time to adjust it becomes lesser To enter in test program the machine has to be turned off or in "stand by" and with the hot water steam knob closed.

These functions can be followed by all the Royal models, because there are almost the same.

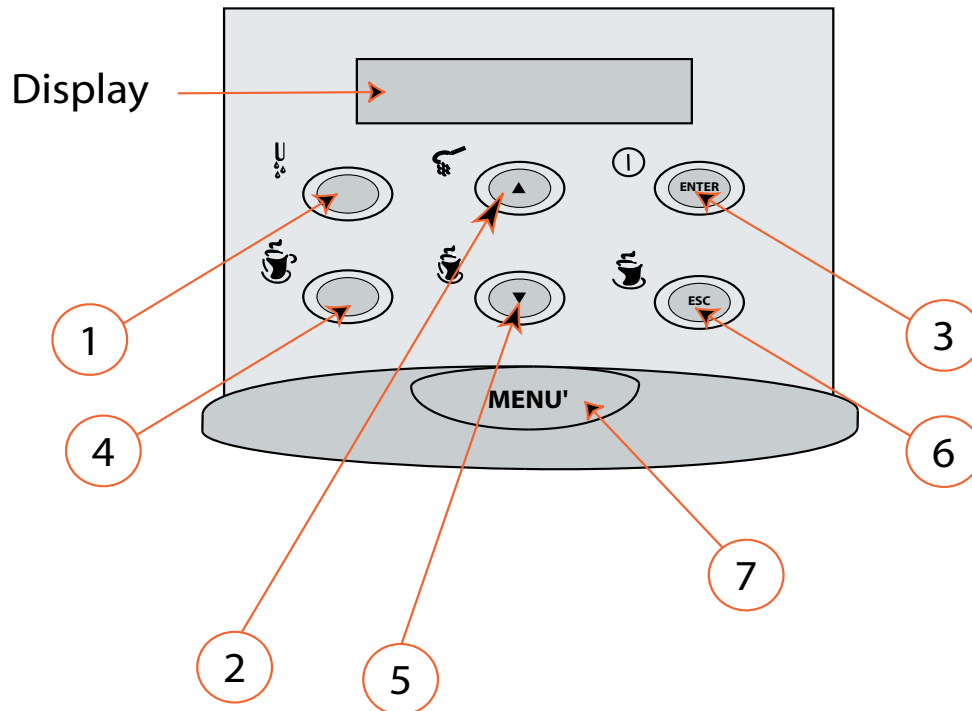

For entering in test programs push the following key's

Push the key' s 2 and 6 in sequence, and turn on the machine at the main switch.

Staying in this position the display is indicating the version of the software. Let go of the key's.
The machine is now in test program.

Rotation anticlockwise gear motor

Key 1

Check the right rotation anticlockwise of the gear motor by checking also the end position

When the gear motor is in work position, on the display it will appear number 1. Check also that the gear motor isn't noisy.

Rotation clockwise gear motor

Key 2

Check the right rotation clockwise of the gear motor by checking also the end position.

When the gear motor is in home position, on the display it will appear number 2. Check also that the gear motor isn't noisy.

Function coffee grinder

Key 3

Check the right function of the coffee grinder, and that the rotation is going clockwise.

Check the noise of the coffee grinder.

When the doser is full, the coffee grinder stops, and on the display appears N° 3

Opening of the doser	Key 4
	<p>Check that the doser isn't noisy.</p> <p>Check the right opening of the coffee doser</p>
Absorbing big resistance coffee boiler	Key's 5 + 2
	Check that the big resistance of the coffee boiler is absorbing
Absorbing small resistance coffee boiler	Key's 5 + 3
	Check that the small resistance of the coffee boiler is absorbing
Absorbing resistance steam boiler	Key's 5 + 4
	Check that the resistance of the steam boiler is absorbing
Function of the pump	Key's 6 + 4
	<p>Check the right function of the pump. Confirm the noise of the pump.</p> <p>On the display the impulses of the flow meter has to rise up to 40.</p>
Leakages inside the machine	Key's 6 + 3 + 4
	<p>Push the key' s in sequence and keep them pushed</p> <p>so the circuit is going into pressure.</p> <p>Now it's possible to check if there is leakages inside the machine.</p> <p>On the display the impulses of the flow meter has to fall until 0</p>
Water flow of the cappuccino device	Key's 3 + 6 + 7
	<p>Check that the water is coming out of the cappuccino device.</p> <p>Check that all of the key' s are switched on.</p>
Temperature of the boilers	Key's 4 + 5 + 6
	Check the temperature of the boilers
Function solenoid valve of the steam boiler	Key's 6 + 4
	Check that the solenoid valve positioned on the steam boiler is opening
Function solenoid valve for hot water	Key's 6 + 2
	Check that the solenoid valve for hot water is opening
Opening of both of the solenoid valves	Key's 6 + 3
	Check the right opening of both of the solenoid valves
Opening of the solenoid valve cappuccino device	Key's 6 + 7
	Check that the solenoid valve of the cappuccino device is opening
Check all the micro switches.	
	<p>Check that on the display appears N°7 (reed sensor for water).</p> <p>Turn the steam knob, check that the micro engages is</p> <p>halfway round and that on the display appears number 4.</p> <p>Activate the micro presence brewin unit and confirm that on the display appears N° 6</p> <p>Remove the coffee grounds container, and check</p> <p>that on the display number 5 is switched off.</p> <p>Activate the micro doser unit and check that on the display appears number 3</p>
Exit the test program	The main switch
	Turn off the machine and then turn it on again.

Test mode ROYAL CAPPUCCINO REDESIGN

In test program it is very easy to locate the broken parts and the time to adjust it becomes lesser.

To enter in test program the machine has to be turned off or in "stand by" and with the hot water steam knob closed.

These functions can be followed by all the Royal models, because there are almost the same.

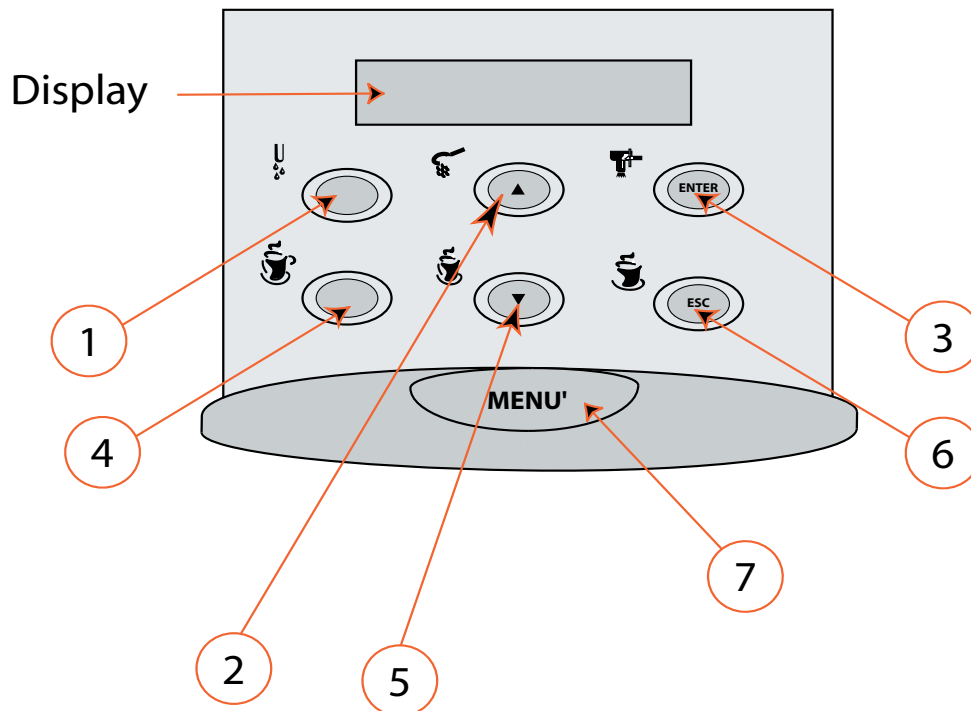

For entering in test programs push the following key's

Push key's 5 and 2 in sequence, and turn on the machine at the main switch or with the key number 7. Staying in this position the display is indicating the version of the software. Let go of the key's. The machine is now in test program.

Rotation clockwise gear motor

Key 1

Check the right rotation anticlockwise of the gear motor by checking also the end position
When the gear motor is in work position, on the display it will appear number 1. Check also that the gear motor isn't noisy.

Rotation anticlockwise gear motor

Key 2

Check the right rotation clockwise of the gear motor by checking also the end position.
When the gear motor is in home position, on the display it will appear number 2. Check also that the gear motor isn't noisy.

Function coffee grinder

Key 3

Check the right rotation of the coffee grinder.
Check the noise of the coffee grinder.

Opening of the doser

Key 4

Check the right opening of the coffee doser.
Check that the doser isn't noisy.

Heating plate for cups	Key's 1 + 5
	Check the function of the heating plate for cups
Absorbing big resistance coffee boiler	Key's 2 + 5
	Check that the big resistance of the coffee boiler is absorbing correctly
Absorbing small resistance coffee boiler	Key's 3 + 5
	Check that the small resistance of the coffee boiler is absorbing correctly
Steam boiler	Key's 4 + 5
	Check that the resistance of the steam boiler is absorbing correctly
Pump 2 (steam)	Key's 1 + 6
	Check the right function of the pump number 2. Check the noise of the pump number 2.
Pump 2 + solenoid valves bypass +steam	Key's 2 + 6
	Check the function of the pump and the solenoid valves
Pump 2 + solenoid valves + hot water+ bypass	Key's 3 + 6
	Check the function of the pump and the solenoid valves
Solenoid valve +bypass	Key's 4 + 6
	Check the right function of the solenoid valve
Pump 1 (coffee/water)	Key's 1 + 5 + 6
	Check the right function of the pump number 1. Check the noise of the pump number 1.
Pump 1 + solenoid valve hot water	Key's 2 + 5 + 6
	Check the right function of the pump and the solenoid valve
Temperature 1 and Temperature 2	Key's 4 + 5 + 6
	Temperature 1. coffee boiler Temperature 2. steam boiler
Led keyboard + solenoid valve cappuccino device.	Key 7
	Check the right functions of all the led Check the function the solenoid valve for the cappuccino device.
Function singular key's	
	Check the functions of the singular key's, There will be indicated on the second line of the display: 1 for key number 1. 2 for key number 2. 3 for key number 3. ecc.

Check all the micro switch

At the first line of the display there will be indicated

the entrance of the micro switches:

1 brewing unit up

2 brewing unit down

3 micro switch doser fuII

4 micro switch water knob

5 micro switch coffee grounds container

6 micro switch presence group

7 sensor level

8 flow meter 1

9 flow meter 2

A jumper free 1 (IP21)

B jumper free 2 (IP22)

Diagnosis Menu

HERE YOU CAN CHANGE AND SET DIFFERENT PARAMETERS AND MACHINE SETTINGS.

TO ENTER THE TEST MODE, PLEASE, PRESS LONG COFFEE+ESPRESSO+STEAM/HOT WATER (OR IN NEW MODELS COFFEE POWDER) BUTTONS WHEN MACHINE IS SWITCHED OFF AND THEN, KEEPING THE FINGERS ON THE BUTTONS SWITCH THE MACHINE ON. IN THE MENU, PLEASE, FOLLOW THE INDICATING ARROWS TO THE POINT "DIAGNOSIS" AND SELECT. WITH THE ARROW BUTTONS YOU CAN SELECT THE PARAMETERS. WITH THE MENU BUTTON AND THE ARROW BUTTONS YOU CAN CHANGE THE SETTING VALUES.

	Maschine Parameter	Range	Function
1	Large coffee N° Impuls 600	50 - 800	Quantity of coffee per cup counted with flowmeter impulses 600 Impulses are appx.. 200 ml
2	Small coffee N° Impuls 150	50 - 800	Quantity of coffee per cup counted with flowmeter impulses 600 Impulses are appx.. 200 ml
3	Coffee N° Impuls 300	50 - 800	Quantity of coffee per cup counted with flowmeter impulses 600 Impulses are appx.. 200 ml
4	Hot water N° Impuls 300	50 - 800 >> Not for Digital/Exc./Stratos	Quantity of water per cup counted with flowmeter impulses 600 Impulses are appx.. 200 ml
5	Cappuccino Seconds 10	5 - 240	Timing set-up dispensing cappuccino
6	Heater Parameter K1 7	1 - 50	Temperature curve management > refrain from adjusting !
7	Heater Parameter K2 30	1 - 50	Temperature curve management > refrain from adjusting !
8	Temp. Normal °C 84	70 - 130 °C	Selected temp. By continous coffee cycle.
9	Temp. High °C 90	70 - 130 °C	Selected temp. when brewing coffee after 6 min.
	Temp. 1° coffee °C 92	70 - 130 °C	Selected temp. When the machine is switch ON or the boiler temperature is lower than 50°C
	Temp. Steam °C 125	70 - 130 °C	Steam temperature
	Temp. Increase °C 10	0 - 50 °C	Controls the right level of temperature > refrain from adjusting
	Steam 35	20 - 50 >> Only Prof./Coffee/Plus	Pump impulses during steam function usage. 20= low impulses 50= high impulses
	Cappuccino 30	20 - 50 >> Only Prof./Coffee	Pump impulses during cappuccino function usage. 20= low impulses 50= high impulses
	Total grounds 3	0 - 50	Counter
	Stop grounds 30	0 - 50	Display shows „empty dregs drawer“
	Total Water S1 ml 1240		Total water quantity flowed trough coffee boiler
	Total desc. S1 ml 1240		Total water quantity flowed trough coffee boiler from last descaling cycle
	Total Water S2 ml 1240	>> Not for Digital/Exc./Stratos	Total water quantity flowed trough steam boiler
	Total desc. S2 ml 1240	>> Not for Digital/Exc./Stratos	Total water quantity flowed trough steam boiler from last descaling cycle
	Hot water flowrate 20 l/h	6 - 34	Flowrate of the pump
	Hot water pump regul. 61500		Pump regulation setting factors. Automatically set-up by the machine.
	Flowmeter factor 28 l/h	6 - 34 >> Only Cappuccino	Pump regulation setting factors for steam. High value = High steam level Low value= Low steam level
	Flowmeter pump regul. 61500	>> Only Cappuccino	Pump regulation setting factors. Automatically set-up by the machine.
	Flowmeter factor 100	>> Only Prof./Coffee/Plus/ Office	Calculation factor related to the flowmeter impulses. If the value is not 100 the machine shows " Ventilate" If the machine is main water net connected the value must be 70
	Machine state 32		Machine functionaly state.
	Prod. Date Day 8		Production date
	Prod. Date Month 10		Production date
	Prod. Date Year 2001		Production date
	Serv. Date Day 10		Service date
	Serv. Date Month 11		Service date
	Serv. Date Year 2001		Service date

>> TO EXIT THE DIAGNOSIS MENU, PLEASE, USE ESC BUTTON OR SIMPLY SWITCH OFF THE MACHINE.